

DM2500 Series

Flanged Ball Valves

SPECIFICATIONS

Available in stainless steel or carbon steel

- Body and ends are investment cast
- Self-adjusting stem packing
- Blow-out proof stem design
- 100% air tested under water at 100 psi
- Working pressure ANSI 150
- Temperature range: -250°F to +700°F
- ISO 5211 mounting pad
- End cap type: flanged end (ANSI 150)
- Flange dimension: face-to-face ANSI B16.10; flange connection ANSI B16.50
- Silicone free
- Oxygen cleaned option



Size	Breakaway Torque (in-lb)	Cv	Weight
1/2"	50	32	9
3/4"	75	54	10
1"	100	105	12
1-1/2"	185	275	18
2"	300	460	25
2-1/2"	450	780	36
3"	750	1330	50
4"	1100	2420	69
6"	3500	5400	189

ORDERING SCHEMATIC

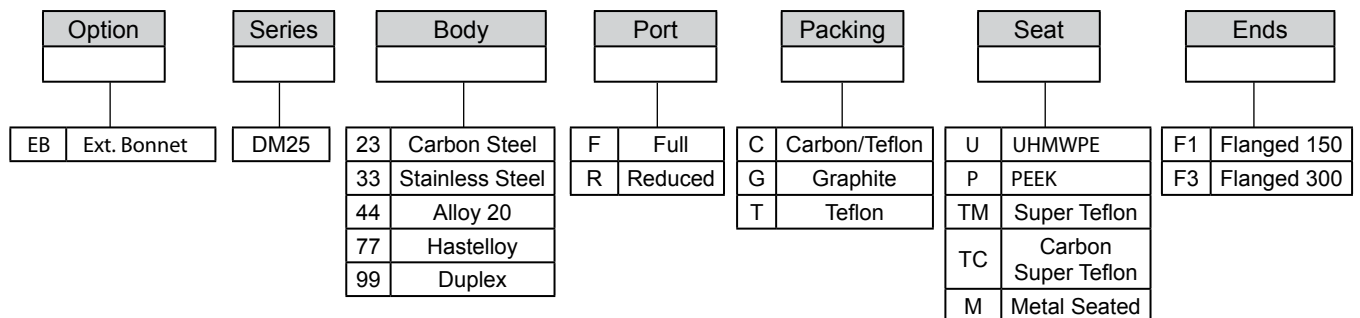

The Right Valve • The Right Application • Right now!

J Flow Controls, LLC
 14 De Camp • Cincinnati, OH 45216
 Phone: 513-731-2900 • Fax 513-731-6939
www.jflowcontrols.com

DIMENSIONS (1/2" 4")

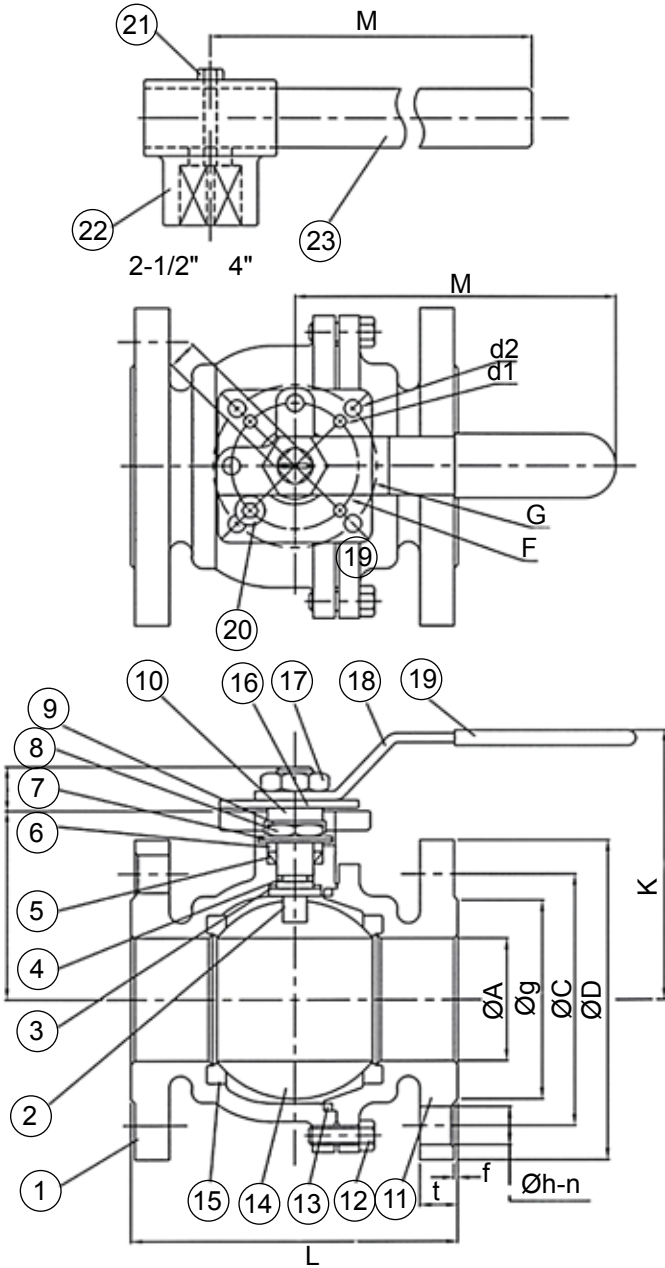

MATERIALS OF CONSTRUCTION

No.	Name of Part	Material Options	
		Stainless Steel	Carbon Steel
1	Body	CF8M/DIN 1.4408	WCB/DIN 1.0619
2	Stem	SS316	
3	Thrust Washer	Teflon	
4	O-Ring	Viton	
5	Stem Packing	Graphite	
6	Gland	SS304	
7	Disc Washer	SS01	
8	Stem Nut	SS304	
9	Nut Lock	SS04	
10	Washer	SS304	
11	Flange Cap	ASTM A351 Gr. CF8M	ASTM A216 Gr. WCB
12	Bolts	SS304	Carbon Steel
13	Gasket	Graphite	
14	Ball	SS316	
15	Ball Seats	Teflon	
16	Stopper	SS304	
17	Handle Nut	SS304	
18	Handle	SS304	
19	Handle Cover	Vinyl Plastisol	
20	Position Pin	SS304	
21	Set Bolt	SS304	
22	Lever Head	CF8	
23	Lever	Steel Pipe	

Size	A	B	E	L	H	K	M	F	G	d1	d2	D	Flange Dimensions (Class 150)					
													Bolt Hole			t	g	f
													c	h	n			
1/2"	0.59	1.89	0.43	4.25	0.35	3.15	5.12	1.42	1.65	0.24	0.24	3.50	2.38	0.63	0.16	0.45	1.38	0.06
3/4"	0.79	2.09	0.43	4.61	0.35	3.15	5.12	1.42	1.65	0.24	0.24	3.86	2.76	0.63	0.16	0.45	1.69	0.06
1"	0.98	2.32	0.55	5.00	0.43	3.54	6.50	1.65	1.97	0.24	0.28	4.25	3.13	0.63	0.16	0.45	2.01	0.06
1-1/4"	1.26	2.80	0.55	5.51	0.43	4.02	6.50	1.65	1.97	0.24	0.28	4.61	3.50	0.63	0.16	0.50	2.52	0.06
1-1/2"	1.42	2.99	0.71	6.50	0.55	4.33	8.07	1.97	2.76	0.28	0.36	5.00	3.88	0.63	0.16	0.56	2.87	0.06
2"	1.97	3.35	0.71	7.00	0.55	4.72	8.07	1.97	2.76	0.28	0.36	5.98	4.74	0.75	0.16	0.63	3.62	0.06
2-1/2"	2.56	3.68	0.91	7.48	0.67	5.51	11.8	2.76	4.02	0.36	0.45	7.01	5.50	0.75	0.16	0.70	4.13	0.06
3"	3.15	4.06	0.91	7.99	0.67	5.91	13.4	2.76	4.02	0.36	0.45	7.48	6.00	0.75	0.16	0.75	5.00	0.06
4"	3.94	5.20	0.98	9.02	0.87	7.09	16.5	4.02	4.92	0.45	0.53	9.02	7.50	0.75	0.31	0.94	5.00	0.06

TEMPERATURE CHART

CHART 1 (ANSI 150/ 285 PSI)

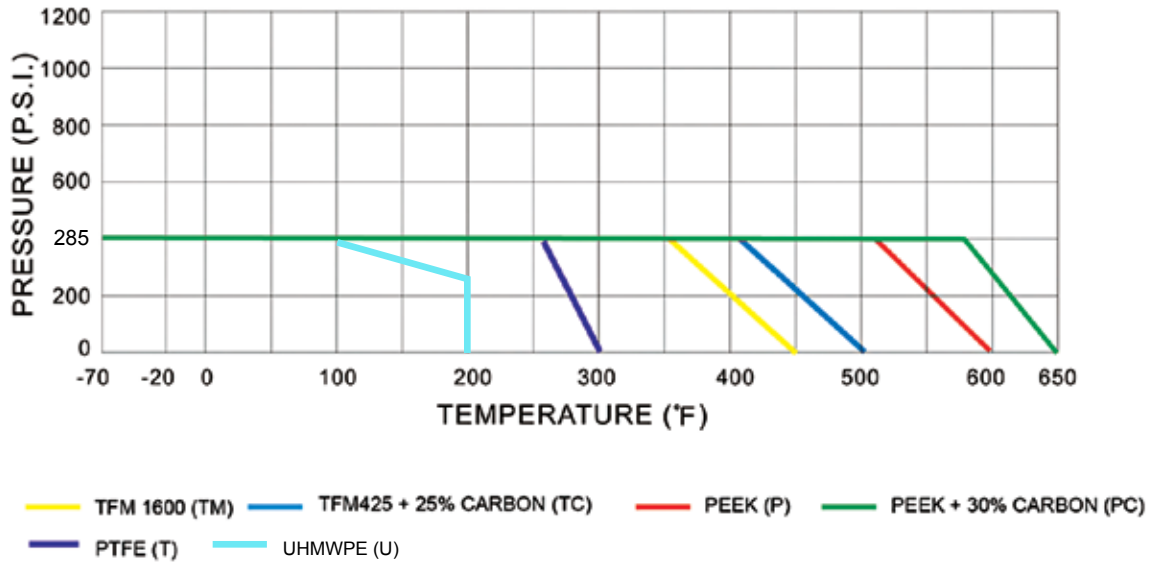

The Right Valve • The Right Application • Right now!

J Flow Controls, LLC
14 De Camp • Cincinnati, OH 45216
Phone: 513-731-2900 • Fax 513-731-6939
www.jflowcontrols.com